

Execution for D= Ø25÷32

Execution for D= Ø36÷50

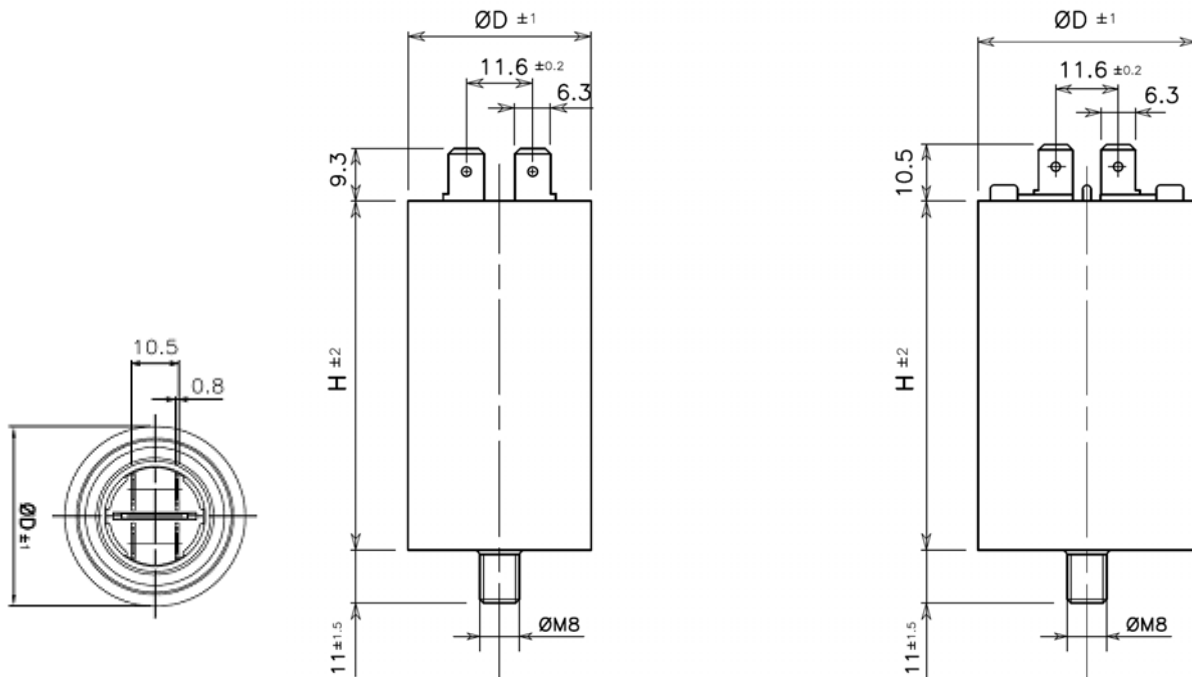

D = 50mm

H = 117mm

with Double-Faston

|    |   |  |
|----|---|--|
|    | Model                                   | 416.10.61..  |
| 1  | Dielectric                              | Self-healing metallized polypropylene  |
| 2  | Filling                                 | Polyurethane resin   |
| 3  | Case material                           | Thermoplastic self-extinguishing V2 class  |
| 4  | Capacitance / Tolerance                 | 60 µF +/-5%  |
| 5  | Rated frequency                         | 50 Hz – 60 Hz  |
| 6  | Rated voltage                           | a) AC 400 V 45 µF ÷ 60 µF<br>b) AC 425 V 2 µF ÷ 40 µF<br>c) AC 450 V 45 µF ÷ 60 µF<br>d) AC 475 V 2 µF ÷ 40 µF |
| 7  | Life expectancy                         | a-b) 10.000h / cl.B<br>c-d) 3.000h / cl.C  |
| 8  | Climatic category                       | 25/85/21   |
| 9  | Class of safety protection              | S0   |
| 10 | Test Voltage between terminals          | 2 U <sub>N</sub> x 2"  |
| 11 | Test Voltage between terminals to case  | 3 kV x 2"  |
| 12 | Insulating Resistance between terminals | 10 x 10 <sup>3</sup> MΩ x µF   |
| 13 | Tan δ                                   | <=20 x 10 <sup>-4</sup><br>measured at the rated voltage, 50Hz, 20°C   |
| 14 | dV/dt (typical)                         | 20 V/µs  |
| 15 | Max torque for M8 threaded fixing stud  | 5 Nm   |
| 16 | Tested and Certified according to       | EN 60252-1/A1  |
| 17 | Certification marks                     | VDE-IMQ  |