

TAS250 Series

Three Phase Current Transformers

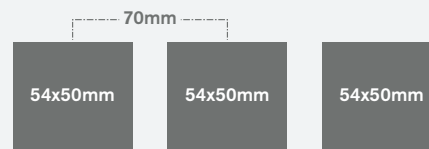

- Foot, busbar or DIN rail mounting
- Fits standard moulded circuit breaker frame sizes
- From 630A to 1600A Primary current input available
- 5A Secondary output
- Sealable terminal covers included
- 214mm width
- 70mm bar centres
- 54 x 50mm apertures



Product Description

The TAS250 is part of the TAS family of three phase current transformers and is one of four frame sizes available. These current transformers have been designed with hole centres and apertures to fit most standard industrial circuit breakers.

This three phase current transformer is suitable for monitoring current in industrial and commercial applications.

Parameters

Primary Current	Burden			Order Code
	Class 0.5 VA	Class 1 VA	Class 3 VA	
630	2.5	5	7.5	0630
800	2.5	5	10	0800
1000	2.5	5	10	1000
1250	5	7.5	15	1250
1600	5	7.5	15	1600

Available with 5A Secondary

Rated Standard

Rated Primary Current (I_{pr})	630...1600A
Frequency Range (f_R)	47...63Hz
Rated continuous current	100% rated current
Rated short time thermal current (I_{th})	$<60 \times I_{pr}$
Rated dynamic current (I_{dyn})	2.5 I_{th}
Instrument security factor (FS)	≤ 5
Rated Secondary output (I_{sr})	5A
Accuracy class	Class 0.5, 1, 3 to IEC/EN61869-2

Insulation

Insulation type	Dry transformer, air insulation
Highest voltage U_m	0.72kV r.m.s.
Rated insulation level	3kV r.m.s. 50Hz/1 min

Environmental Conditions

Reference temperature	23°C $\pm 1^\circ\text{C}$
Nominal temperature range	-25°C...40°C
Daily mean temperature	$\leq 30^\circ\text{C}$
Limit temperature range for storage	-40°C...85°C
Relative humidity	$\leq 85\%$ non condensing

Housing

Housing material	Self extinguishing Nylon
Protection degree	IP20
Secondary Terminals	M4 screws
Mounting	Foot mounting, busbar mounting or snap on 35mm DIN rail mounting
Weight	1200g

Dimensions (mm)

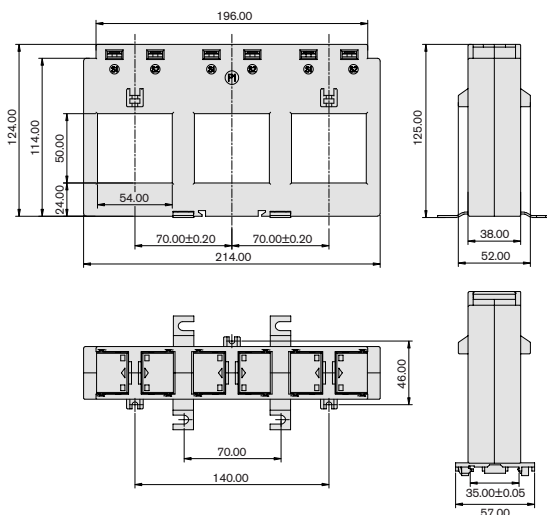

Information Required with Order

Build your order number - example	TAS250	5A	0630
Model			
Secondary Current			
Primary Current Range - See Parameters Table 'Order Code'			